



LIVING FIRE



# TRUE NORTH WOOD HEATERS

**TN10 & TN20 FREESTANDING  
TN20 INBUILT**



*Made in Canada,  
for Canadian Winters*

## FREESTANDING

True North wood heaters offer an exceptional cost to performance ratio. Featuring quad burn tubes as part of the combustion system, and fully firebrick lined, the TN10 and TN20 are an effective solution for a price-minded wood heater. Each wood heater is engineered for high efficiency and constructed with 10-gauge steel, a gasketed cast iron door, and a clean glass airwash system. 100% made in Canada with a 5 year warranty.



### TN10 FREESTANDING

<b>Heat Output</b>	<b>120–150 m<sup>2</sup></b>	
Efficiency	★★★★★	64%
Emissions	★★★★★	1.2 gm/kg
Burn Time	6–8 hours	
Log Size (max)	25–30 cm	
Weight	89 kg	

### TN20 FREESTANDING

<b>Heat Output</b>	<b>200–220 m<sup>2</sup></b>	
Efficiency	★★★★★	62%
Emissions	★★★★★	1.1 gm/kg
Burn Time	8–12 hours	
Log Size (max)	40–45 cm	
Weight	154 kg	

### FEATURES

Reliable catalytic-free technology  
Boost air  
Heavy plate-steel top  
Leg and pedestal model available (TN20 only)

Even heat distribution  
Quad burn performance with 4 secondary airtubes  
Air wash system for super clean ceramic glass

Inside and outside combustion air capable  
Single-Lever Air Control  
Cast iron door  
Optional fan



## INBUILT

Convert an existing fireplace into a source of efficient heat with the TN20 inbuilt wood heater. This powerful firebox will heat small to medium spaces, burn cleanly and will offer years of trouble free warmth. The gasketed cast iron door seals the firebox to avoid unnecessary air loss, while clean air-wash technology ensures a full view of the fire while in use.



### TN20 INBUILT

<b>Heat Output</b>	<b>200–220 m<sup>2</sup></b>	
Efficiency	★★★★★	67%
Emissions	★★★★★	1.2 gm/kg
Burn Time	8–12 hours	
Log Size (max)	40–45 cm	
Weight	128 kg	



### FEATURES

Reliable catalytic-free technology  
Even heat distribution  
Quad burn performance with  
4 secondary airtubes

Air wash system for super clean  
ceramic glass  
Inside and outside combustion  
air capable

Single-Lever Air Control  
Cast iron door  
Fan standard

## TN10 FREESTANDING

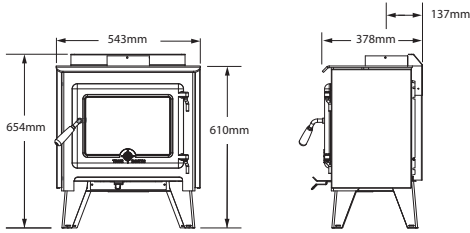

### CLEARANCES TO COMBUSTIBLES (MM)

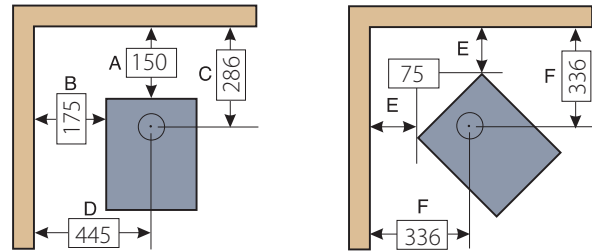

## TN20 FREESTANDING

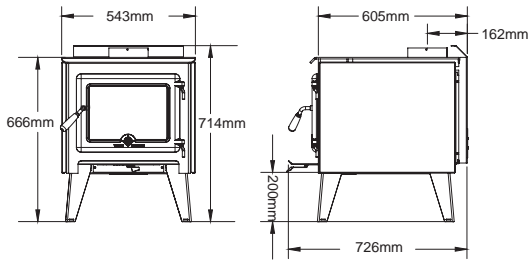

### CLEARANCES TO COMBUSTIBLES (MM)

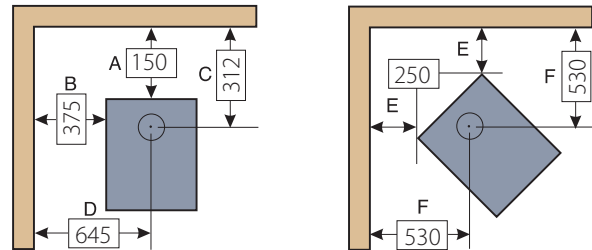

## TN20 INBUILT

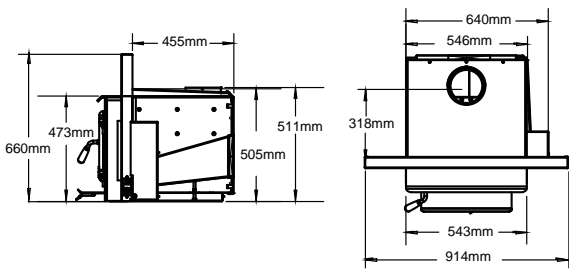

### MINIMUM FIREPLACE OPENING (MM)

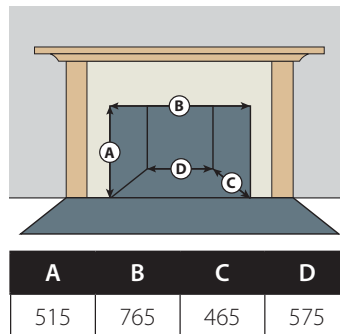

### CLEARANCES TO COMBUSTIBLES (MM)

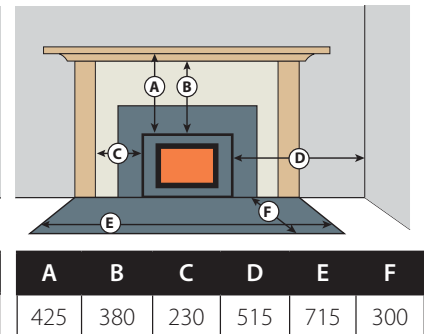

### HEARTH REQUIREMENTS (MM)

	Minimum Floor Protector (width x length)	Extending in front of door opening	From side of door opening	Thickness
<b>TN10 FREESTANDING</b>	715 x 640	300	200	9
<b>TN20 FREESTANDING</b>	714 x 1090	300	200	9
<b>TN20 INBUILT (545w x 720d x 110 thick Clay Bricks)</b>	715 x 450	300	200	9

\* all products subject to change without warning Due to the limitations of the printing process, it is not possible to replicate colours exactly in a print format. Please check with your local Pacific Energy retailer for colour samples.



LIVING FIRE

PAUL AGNEW DESIGNS

Richmond Showroom:  
361 Swan Street, Richmond 3121

Bayside Showroom:  
148-150 Cochrane Rd, Moorabbin 3189

03 99 777 888

www.livingfire.com.au